

CLASSIC

TRAVEL TRAILERS | FIFTH WHEELS
BY **Flagstaff**

PROUDLY
Millersburg Made
SINCE 1974



FOREST
RIVER

Classic Travel Trailers

EXPERIENCE MODERN RESIDENTIAL LUXURY WITH SPACIOUS INTERIORS IN A TRAVEL TRAILER!

Flagstaff's 2024 Classic Travel Trailers need no introduction, but let's walk through some of the amazing features it has to offer. Modern standard amenities include a 200W roof mount solar with 30A charge controller, 1800W inverter with inverted outlets, aluminum framed dinettes and bed bases, hybrid woven flooring in flush floor slides, Showermiser water saving system, day/night roller shades, and so much more!

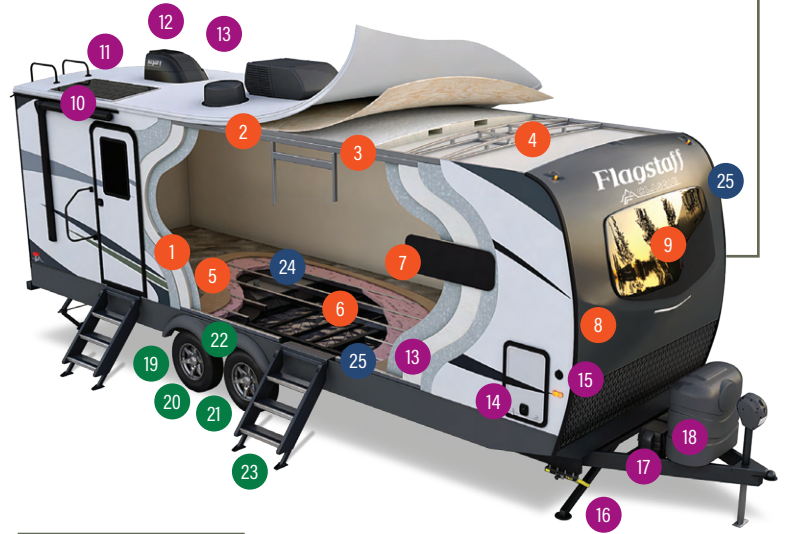

Interior Options



Acadia & Sedona Wood
w/Autumn Wood
Accents



Mojave & Sedona Wood
w/Autumn Wood
Accents

SUPERIOR CONSTRUCTION

1. Complete **Composite** Wall Construction
2. Fully Laminated Walkable Roof
3. Six-Sided Full-Aluminum Frame
4. Aluminum Truss Roof Bracing
5. 5/8" Tongue & Groove Plywood Floor
6. Aluminum Floor Joists
7. Frameless Windows
8. Painted Fiberglass Front Cap with Clear Coat
9. Automotive Glass Windshield

STANDARD FEATURES

10. 200W Solar Panel w/1800W Inverter & 30A Charge Controller
11. Back-Up Camera Prep
12. Maxxair® Fan with Cover
13. Winegard Air 360+ Prepped for Wi-Fi
14. Key-Alike Lock System
15. Additional Solar Prep
16. PSX2 Power Stabilizers
17. Double Battery Boxes
18. Double 30 Lb. LP Tanks

SAFETY STANDARDS

19. TST Tire Pressure Monitor System
20. Goodyear Endurance Tires
21. Nitrogen-Filled Tires
22. Dexter® Torflex® Axles
23. MORryde® Strut Assist Steps

CLIMATE PROTECTION PACKAGE

24. 12V Thermostat-Controlled Heated Tanks
25. Radiant Foil in Underbelly, Front Caps & Slides

OPTIONAL FEATURES

26. Auto Leveling

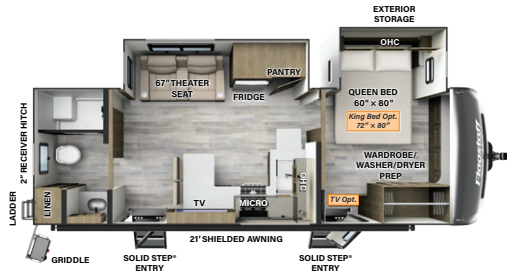
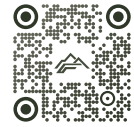

826RBS

LENGTH: 29' 11" WIDTH: 8' HEIGHT: 11' 7" HITCH: 1070 AXLE: 6580

UVW: 7709 CCC: 2161 **F** 54 GAL **G** 69 GAL **B** 39 GAL



826MBR

LENGTH: 29' 11" WIDTH: 8' HEIGHT: 11' 7" HITCH: 1065 AXLE: 6685

UVW: 7809 CCC: 2056 **F** 54 GAL **G** 78 GAL **B** 39 GAL

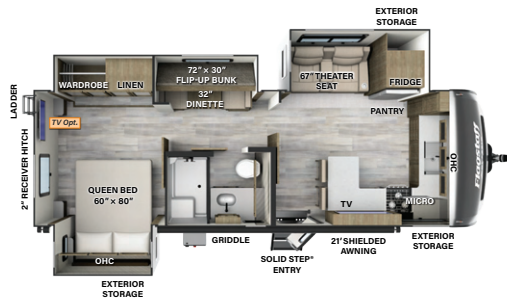

826BHS

LENGTH: 29' 11" WIDTH: 8' HEIGHT: 11' 7" HITCH: 1000 AXLE: 7220

UVW: 8279 CCC: 1521 **F** 54 GAL **G** 92 GAL **B** 53 GAL

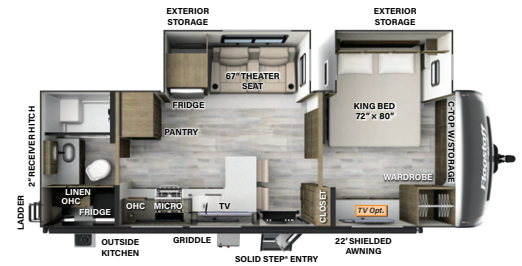

NEW!
826KBS

LENGTH: 29' 11" WIDTH: 8' HEIGHT: 11' 7" HITCH: 1010 AXLE: 6580

UVW: 7649 CCC: 2161 **F** 54 GAL **G** 78 GAL **B** 39 GAL

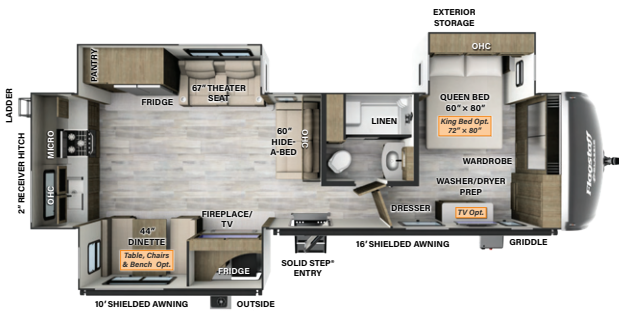

832RKSB

LENGTH: 36' 8" WIDTH: 8' HEIGHT: 11' 7" HITCH: 1266 AXLE: 8259

UVW: 9584 CCC: 1682 **F** 54 GAL **G** 113 GAL **B** 53 GAL

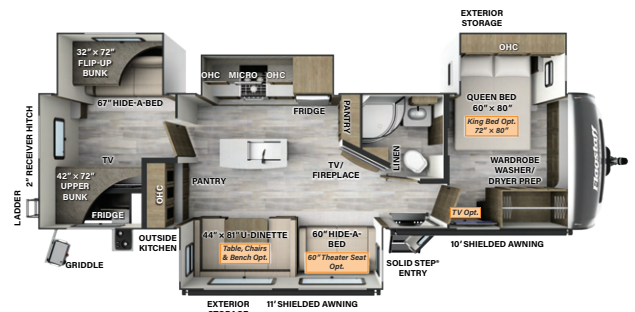

832BWS

LENGTH: 36' 8" WIDTH: 8' HEIGHT: 11' 7" HITCH: 1320 AXLE: 8290

UVW: 9669 CCC: 1651 **F** 54 GAL **G** 131 GAL **B** 53 GAL

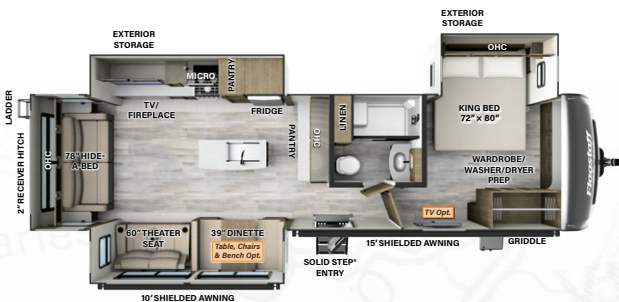

832IKRL

LENGTH: 36' 8" WIDTH: 8' HEIGHT: 11' 7" HITCH: 1375 AXLE: 8020

UVW: 9454 CCC: 1921 **F** 54 GAL **G** 122 GAL **B** 53 GAL



NEW!
832DBS

LENGTH: 36' 10" WIDTH: 8' HEIGHT: 11' 7" HITCH: 1370 AXLE: 8351

UVW: 9780 CCC: 1590 **F** 54 GAL **G** 122 GAL **B** 53 GAL

Classic Fifth Wheels

EXPERIENCE LUXURIOUS NEXT-LEVEL CAMPING WITH FLAGSTAFF CLASSIC FIFTH WHEELS.

Flagstaff's quality and superior construction reputation precedes itself in 2024 with Classic Fifth Wheels. The finest creature comforts were implemented during development of the Classic series. Amenities include electric auto leveling, hybrid carpet, residential brick fireplace surround, upgraded solid-surface countertops, and even residential style soft-close drawers.

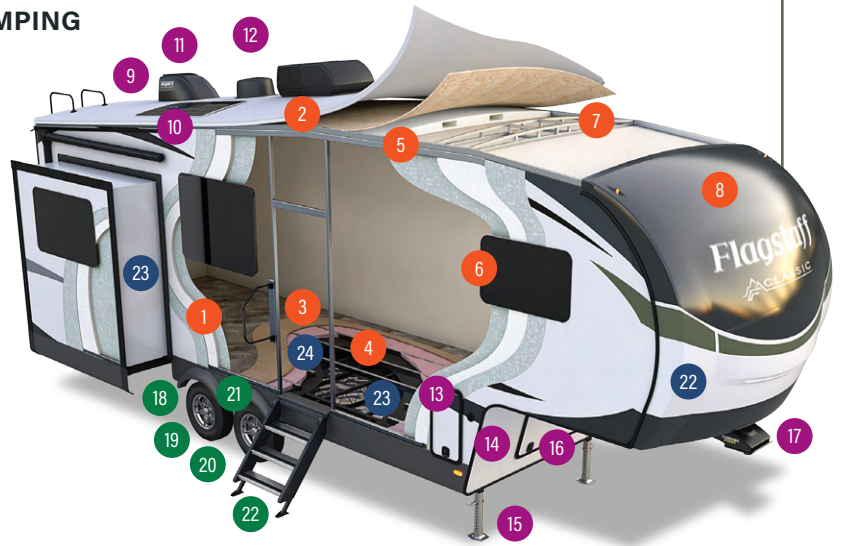

Interior Options



Acadia & Sedona Wood
w/ Autumn Wood
Accents



Mojave & Sedona Wood

SUPERIOR CONSTRUCTION

1. Complete **Composite** Wall Construction
2. Fully Laminated Walkable Roof
3. 5/8" Tongue & Groove Plywood Floor
4. Aluminum Floor Joists
5. Six-Sided Full-Aluminum Frame
6. Frameless Windows
7. Aluminum Truss Roof Bracing
8. Painted Fiberglass Front Cap with Clear Coat

STANDARD FEATURES

9. Back-Up Camera Prep
10. 200W Solar Panel w/1800W Inverter & 30A Charge Controller
11. Maxxair® Fan with Cover
12. Winegard Air 360+ Prepped for Wi-Fi
13. Double 30 Lb. LP Tanks
14. Additional Solar Prep
15. Auto-Leveling w/Lippert™ Rota-Flex Pin Box¹
16. Key-Alike Lock System
17. Lippert Turning Point Pin Box

SAFETY STANDARDS

18. TST Tire Pressure Monitor System
19. 16" E-Rated Goodyear Endurance Tires
20. Nitrogen-Filled Tires
21. Dexter® Torflex® Axles
22. MORryde Strut Assist Steps

CLIMATE PROTECTION PACKAGE

23. Radiant Foil in Underbelly, Front Caps & Slides
24. 12V Thermostat-Controlled Heated Tanks

¹ Optional on F281RK, F282RD, F301RK: Units without auto-leveling will have the Lippert™ Turning Point Pin Box

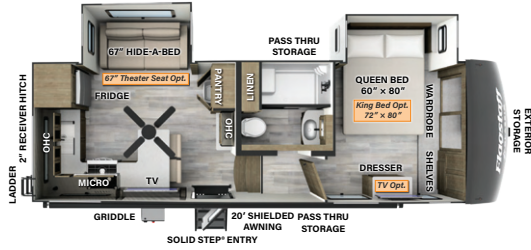
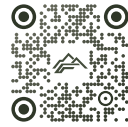

F281RK

LENGTH: 28' 11" WIDTH: 8' HEIGHT: 13' 1" HITCH: 1236 AXLE: 6952

UVW: 8247 CCC: 1589 **F** 54 GAL **G** 78 GAL **B** 39 GAL

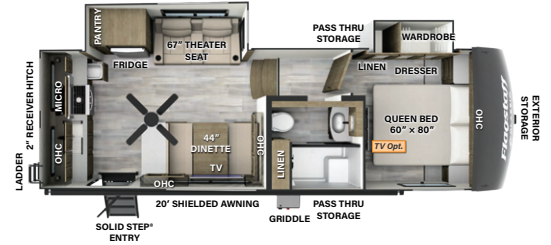

NEW!
F282RD

LENGTH: 28' 11" WIDTH: 8' HEIGHT: 13' 1" HITCH: 1500 AXLE: 6445

UVW: 8004 CCC: 1996 **F** 54 GAL **G** 78 GAL **B** 39 GAL

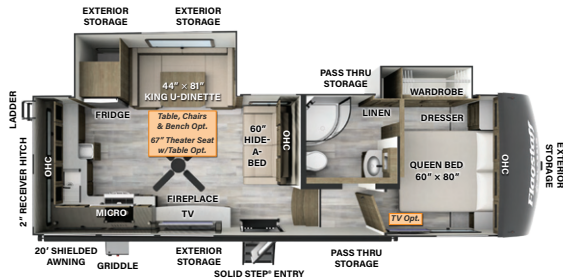

F301RK

LENGTH: 30' 8" WIDTH: 8' HEIGHT: 13' 1" HITCH: 1410 AXLE: 7000

UVW: 8469 CCC: 1527 **F** 54 GAL **G** 78 GAL **B** 39 GAL

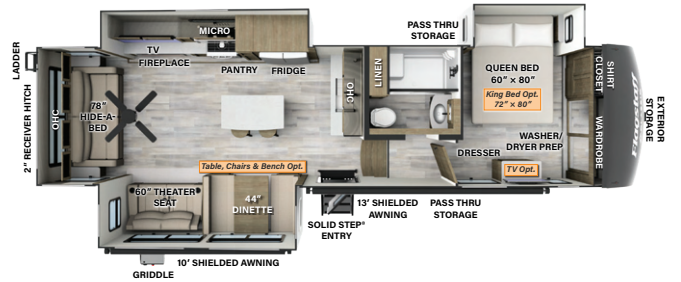

F361RL

LENGTH: 36' 2" WIDTH: 8' HEIGHT: 13' 2" HITCH: 1818 AXLE: 8564

UVW: 10441 CCC: 1777 **F** 54 GAL **G** 92 GAL **B** 53 GAL

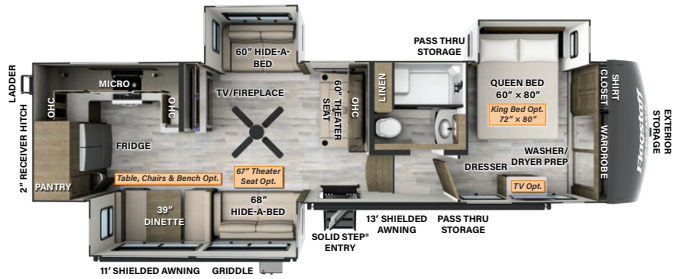

F371RK

LENGTH: 36' 8" WIDTH: 8' HEIGHT: 13' 2" HITCH: 1918 AXLE: 8424

UVW: 10401 CCC: 1917 **F** 54 GAL **G** 92 GAL **B** 53 GAL

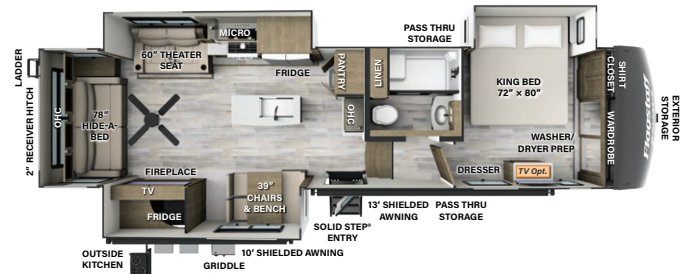

F372RL

LENGTH: 36' 8" WIDTH: 8' HEIGHT: 13' 2" HITCH: 1905 AXLE: 8880

UVW: 10844 CCC: 1461 **F** 54 GAL **G** 83 GAL **B** 53 GAL



Millersburg, Indiana is a special place with special people. This is a town built upon care, craftsmanship, and teamwork. Millersburg is our home and we're grateful for the opportunity to employ many of our neighbors, friends, and families. Flagstaff is a proud employer of multiple generations of Millersburg residents and our quality-first reputation is second to none, thanks to our Millersburg home.

We're happy to have zero stoplights, two banks, two parks, one gas station, one car mechanic, an elementary school, and a few churches in our humble corner of Elkhart County. We work hard, care, build, craft, and take care of each other and our families. Millersburg keeps North America camping, one Flagstaff at a time, made with pride and value.

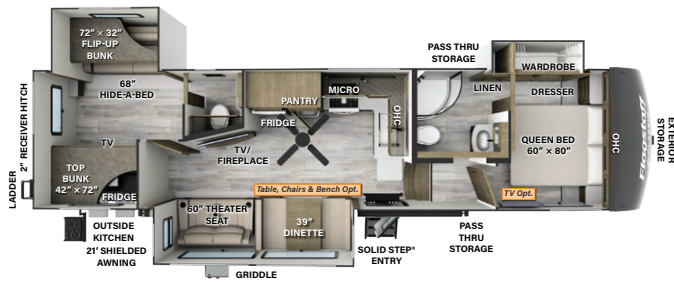
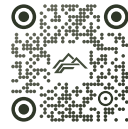

F373BH

LENGTH: 36' 8" WIDTH: 8' HEIGHT: 13' 2" HITCH: 1730 AXLE: 8626

UVW: 10415 CCC: 1715 **F** 54 GAL **G** 92 GAL **B** 92 GAL

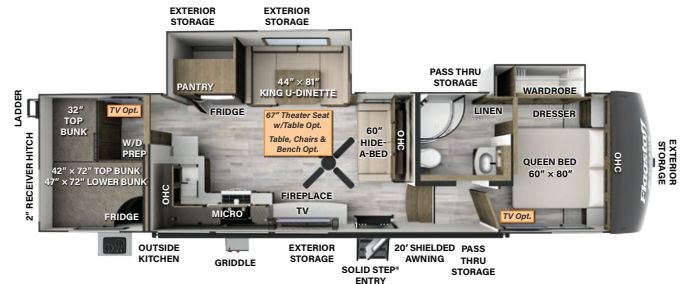

F374BH

LENGTH: 36' 8" WIDTH: 8' HEIGHT: 13' 2" HITCH: 1649 AXLE: 8051

UVW: 9759 CCC: 1890 **F** 54 GAL **G** 92 GAL **B** 53 GAL

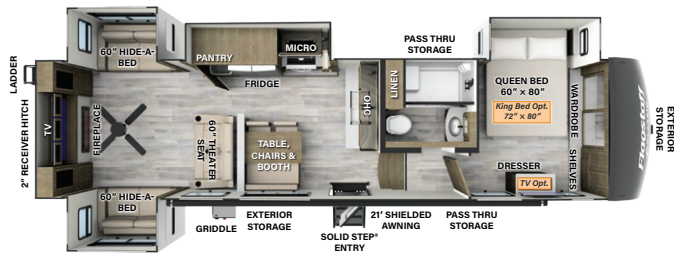

F375RL

LENGTH: 36' 8" WIDTH: 8' HEIGHT: 13' 2" HITCH: 1740 AXLE: 8580

UVW: 10379 CCC: 1761 **F** 54 GAL **G** 92 GAL **B** 53 GAL

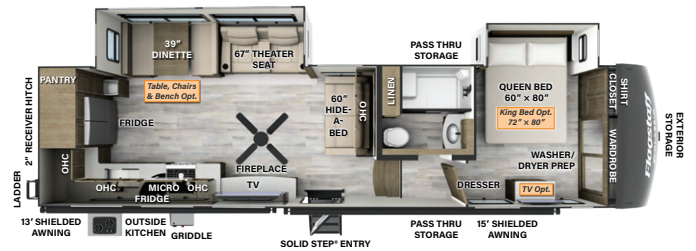

NEW!
F376RK

LENGTH: 36' 8" WIDTH: 8' HEIGHT: 13' 2" HITCH: 1960 AXLE: 8170

UVW: 10189 CCC: 2171 **F** 54 GAL **G** 92 GAL **B** 53 GAL

EXPERIENCE LIMITLESS RVING POWER!*

POWER
PACKAGE

Whether boondocking or going off-grid, the Classic Fifth Wheel Power Package option was designed for outdoor enthusiasts who love adventure.

Includes:

- Charge at Home from a 15A Receptacle with Combimaster Power Sharing Feature
- 460Ah Lithium-Ion Battery; Optional Additional 460Ah Battery
- 3.5kW Inverter-Charger
- 200A Charge Capacity
- (6) 200W GoPower® Solar Panels
- Integrated 60A MPPT Charge Controller
- 5" Touchscreen Monitor
- Centralized System Disconnect Switch
- 15,000 BTU A/C w/Soft Start Technology

*Power Package available in Select Fifth Wheel Models Only. Look for the Icon Next to the Floorplan.

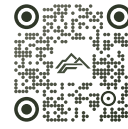

Slide Options

| Model | 60" Theater Seat | 67" Theater Seat | Table, Chairs & Bench | King Bed |
|-------------------------|------------------|------------------|-----------------------|----------|
| Classic Travel Trailers | | | | |
| 826RBS | | Standard | | ✓ |
| 826MBR | | Standard | | Standard |
| 826BHS | | Standard | | |
| 826KBS | | Standard | | ✓ |
| 832RKSB | Standard | | ✓ | Standard |
| 832BWS | ✓ | | ✓ | ✓ |
| 832IKRL | Standard | | ✓ | Standard |
| 832DBS | ✓ | | ✓ | ✓ |
| Classic Fifth Wheels | | | | |
| F281RK | | ✓ | | ✓ |
| F282RD | | Standard | | |
| F301RK | | ✓ | ✓ | |
| F361RL | Standard | | ✓ | ✓ |
| F371RK | | ✓ | ✓ | ✓ |
| F372RL | Standard | | | Standard |
| F373BH | Standard | | ✓ | |
| F374BH | | ✓ | | |
| F375RL | Standard | | ✓ | ✓ |
| F376RK | | Standard | ✓ | ✓ |



MOBILE DEVICE CONTROL!

Your RV is equipped with Lippert™ One Control®. This WiFi app-based interface provides comfort and convenience to control and monitor your RV's functions.

With the WeRV app you can control your lights, slides and awning from your fingertips.

For a complete list of control capabilities, please visit lippert.com/onecontrol

Whenever, wherever we make your experience better.



Download the WeRV App!





Apple and App Store are registered trademarks of Apple Inc. Google Play and the Google Play logo are trademarks of Google LLC.

CUSTOMER SATISFACTION



Flagstaff Warranty. Our Promise.

www.ForestRiverBuyLocal.com

FOR DETAILS ON ROCKWOOD'S COMPLETE WARRANTY PROGRAM, SEE YOUR ROCKWOOD DEALER.

When it comes to backing products with the same quality and commitment it does when it begins the manufacturing process, the only name you have to remember when you're looking for a recreational vehicle is Flagstaff. Flagstaff offers the following additional limited warranties to the original purchasers. Consult written warranty for details.

1 Limited lifetime roofing warranty*

2 Two-year fiberglass warranty.

3 Ten-year Torflex® axle warranty.

4 One-year bumper to bumper warranty.

*Lifetime warranty is limited to original owner

Specification Definitions

GVWR (Gross Vehicle Weight Rating): is the maximum permissible weight of the unit when fully loaded. It includes all weights, inclusive of all fluids, cargo, optional equipment and accessories. For safety and product performance do NOT exceed the GVWR.

GAWR (Gross Axle Weight Rating): is the maximum permissible weight, including cargo, fluids, optional equipment and accessories that can be safely supported by a combination of all axles.

UVW (Unloaded Vehicle Weight):¹ is the typical weight of the unit as manufactured at the factory. It includes all weight at the unit's axle(s) and tongue or pin and LP Gas. The UVW does not include cargo, fresh potable water, additional optional equipment or dealer installed accessories.

CCC (Cargo Carrying Capacity):¹ is the amount of weight available for fresh potable water, cargo, additional optional equipment and accessories. CCC is equal to GVWR minus UVW. Available CCC should accommodate fresh potable water (8.3 IWW per gallon). Before filling the fresh water tank, empty the black and gray tanks to provide for more cargo capacity.

Each Forest River RV is weighed at the manufacturing facility prior to shipping. A label identifying the unloaded vehicle weight of the actual unit and the cargo carrying capacity is applied to every Forest River RV prior to leaving our facilities.

The load capacity of your unit is designated by weight, not by volume, so you cannot necessarily use all available space when loading your unit.

All information contained in this brochure is believed to be accurate at the time of publication. However, during the model year, it may be necessary to make revisions and Forest River, Inc., reserves the right to make all such changes without notice, including prices, colors, materials, equipment and specifications as well as the addition of new models and the discontinuance of models shown in this brochure. Therefore, please consult with your Forest River dealer and confirm the existence of any materials, design or specifications that are material to your purchase decision. © 2023 Flagstaff RV, a Division of Forest River, Inc., a Berkshire Hathaway Company. All Rights Reserved. 12/29 Flagstaff

1 Estimated Average based on standard build optional equipment



PRE-DELIVERY INSPECTION FACILITY
20,000 square feet of quality assurance. The bare essentials for a premium product. This state-of-the-art facility gives immediate daily feedback to production for quality assurance in every unit built.



RV WITH US



@FlagstaffRVs



FOREST RIVER OWNER'S GUIDE

Now you can have your Owner's Manual with you wherever you are. Download our FREE App from the App Store or Google Play and you'll have the information right at your fingertips.

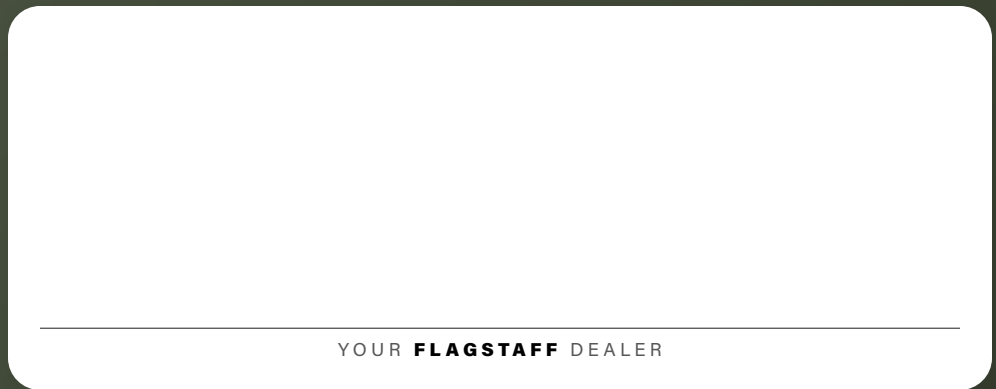

YOUR **FLAGSTAFF** DEALER



Learn More
Scan this barcode using a QR Reader on your smart phone to learn more about Forest River.



A Berkshire Hathaway company

Flagstaff

201 WEST ELM MILLERSBURG, IN 46543
WWW.FORESTRIVERINC.COM/FLAGSTAFF

574.642.2640

FREE MEMBERSHIP
to Forest River Owners' Group

www.forestriverfrog.com

